

SERIES 20 REAR VENTILATED RAINSCREEN

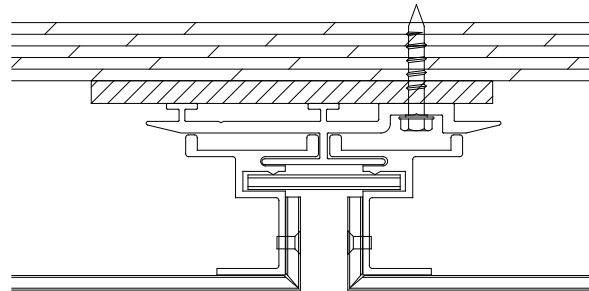

**METAL
DESIGN
SYSTEMS**

DESIGNED FOR
A PERFECT FIT.

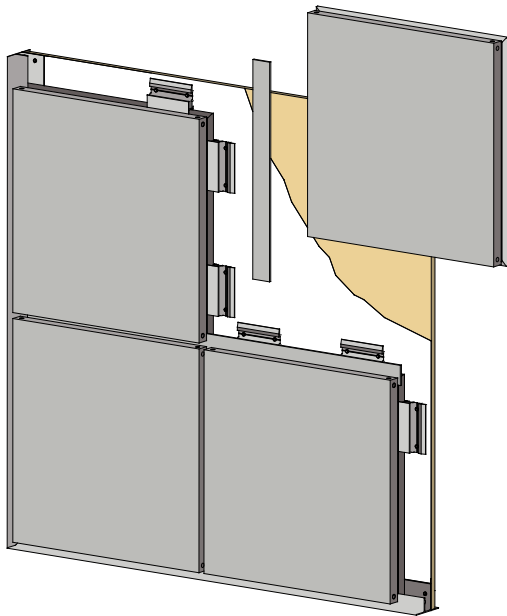

THE SERIES 20 is our most popular system with no caulk or silicone and virtually maintenance free. This innovative system features a full perimeter extrusion frame in each panel and utilizes a shared clip to the wall structure, ensuring a professional look. This completed system is very clean and attractive.

SERIES 20 System Features

System	Rear Ventiladed Rainscreen
Joint Type/Size	Dry Joint - No Caulk
Progressive System	Progressive Installation
Underlayment	Ice & Water Shield Recommended
Sheathing Over Studs	5/8" Plywood Preferred
Curved Surfaces	Hard
Independently Tested	ASTM E283, E331, E330, AAMA 501, 508** ** Pressure Equalized - please request standard details
Maintenance Free	Yes
Allow for Thermal Expansion	No
Price	Higher
Weather Sealed System	No
Ease of Installation	Medium

SERIES 20 REAR VENTILATED RAINSCREEN

Face Material:

Alpolic
 Reynobond
 Aluminum Plate
*See Manufacture's Product
 Data for Technical Information*

Thickness:

3MM (.118") Special Order
 4MM (.157") Standard
 6MM (.236") Special Order

System Depth:

2" minimum, 2 1/4" design

Performance Testing:

ASTM E 283 - Static Air Infiltration
 ASTM E 331 - Static Water Infiltration
 AAMA 501 - Dynamic Water Infiltration
 AAMA 508** - Pressure Equalization
 ** Pressure Equalized - please request standard details
 ASTM E 330 - Structural Design Loads (40psf)

Joint Width:

1/2" or 3/4" typical

Recommended Panel Module Sizes:

Any Combination of Width & Length

Width	Length
60"	192"
48"	144"
28"	96"
22"	70"
18"	63"

Panel Tolerance:

Width: 0.08"
 Length: 0.08"
 Thickness: 0.04"
 Square: 0.2"
 Bow: Max. 0.57% of length and/or width

Panel Extrusions:

Aluminum Alloy: 6063-T6
 Panel Perimeter Extrusion: Continuous
 Wall Clips: 4" long 16" O.C.

Maximum Panel Size:

60" x 192"

SERIES 20 Recommended Fasteners

Dyna-Coat Torx
 T-17 12-11 x 1-1/4"

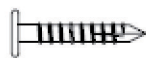

For attaching extrusions to wood substrat when a low profile head is required. 1" penetration into wood required.

#12 Wood Screw

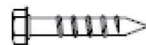

For attaching extrusions or attachment clips to wood surfaces. Must be long enough to penetrate 1" into wood.

Dril-Flex #12 or equal



For attaching extrusions to aluminum or steel surfaces. Must be long enough to penetrate with at least 3 threads visible from back side of attachment.

1/4" Tapcon



Use for attachment of clips and extrusion to masonry surfaces. Minimum 2" from any edge to avoid structural spalling.



**METAL
 DESIGN
 SYSTEMS**
 DESIGNED FOR
 A PERFECT FIT.

4150 C Street SW | P.O. Box 1165 | Cedar Rapids, IA | 52406-1165

319-362-7454 | Toll Free 866-442-6803 | Fax 319-396-2935

METALDESIGNSYSTEMS.COM