

SERIES 40 SG NON-PROGRESSIVE SILICONE GASKET

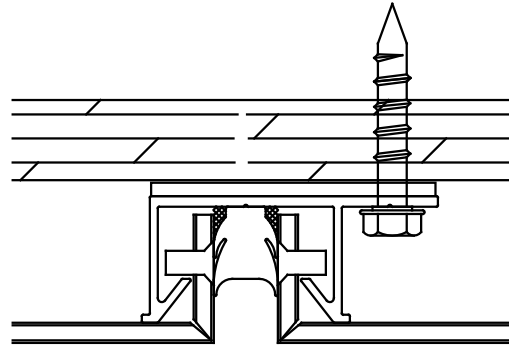

**METAL
DESIGN
SYSTEMS**

DESIGNED FOR
A PERFECT FIT.

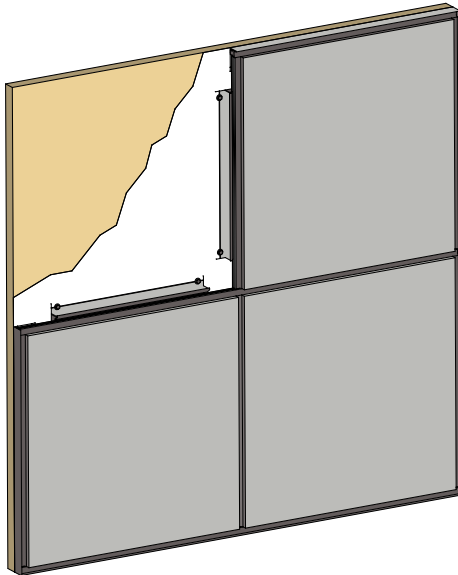

THE SERIES 40 SG is easy to install due to the semi-continuous attachment extrusions and the innovative lock-in-place backer wedge. This system is available as a wet sealed caulk system or with an option for silicone gasket.

Since the Series 40 SG is a non-progressive system, any panel can be removed or replaced without removing adjacent panels, further adding to the desirability of this system. The Series 40 SG allows for thermal movement and when installed, it offers and holds clean lines and optimizes panel to panel alignment.

SERIES 40 SG System Features

System	Non-Progressive
Joint Type/Size	Caulked or Silicone Gasketed
Progressive System	Non-Progressive Installation
Underlayment	Tyvek Recommended
Sheathing Over Studs	Not required - 5/8" Plywood Preferred
Curved Surfaces	Excellent for Radius Applications
Independently Tested	ASTM E283, E331, E330 & AAMA 501
Maintenance Free	No
Allow for Thermal Expansion	Yes
Price	Medium Priced
Weather Sealed System	Yes
Ease of Installation	Easy

SERIES 40 SG NON-PROGRESSIVE SILICONE GASKET

Face Material:

Alpolic

Reynobond

See Manufacture's Product Data for Technical Information

Thickness:

4MM (.157") Standard

System Depth:

1 1/8" minimum, 1 1/4" design

Performance Testing:

- ASTM E 283 - Static Air Infiltration
- ASTM E 331 - Static Water Infiltration
- AAMA 501 - Dynamic Water Infiltration
- ASTM E 330 - Structural Design Loads (40psf)

Joint Width:

1/2"

Recommended Panel Module Sizes:

Any Combination of Width & Length

Width	Length
60"	192"
48"	144"
28"	96"
22"	70"
18"	63"

Panel Tolerance:

- Width: 0.08"
- Length: 0.08"
- Thickness: 0.04"
- Square: 0.2"
- Bow: Max. 0.57% of length and/or width

Panel Extrusions:

- Aluminum Alloy: 6063-T6
- Panel Perimeter Extrusion: Semi-Continuous

Maximum Panel Size:

60" x 192"

SERIES 40 SG Recommended Fasteners

Dyna-Coat Torx
T-17 12-11 x 1-1/4"

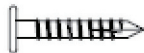

For attaching extrusions to wood substrate when a low profile head is required. 1" penetration into wood required.

#12 Wood Screw

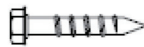

For attaching extrusions or attachment clips to wood surfaces. Must be long enough to penetrate 1" into wood.

Dril-Flex #12 or equa



For attaching extrusions to aluminum or steel surfaces. Must be long enough to penetrate with at least 3 threads visible from back side of attachment.

1/4" Tapcon



Use for attachment of clips and extrusion to masonry surfaces. Minimum 2" from any edge to avoid structural spalling.



**METAL
DESIGN
SYSTEMS**

DESIGNED FOR
A PERFECT FIT.

4150 C Street SW | P.O. Box 1165 | Cedar Rapids, IA | 52406-1165

319-362-7454 | Toll Free 866-442-6803 | Fax 319-396-2935

METALDESIGNSYSTEMS.COM